

Stamped Concrete Cross Walk - New

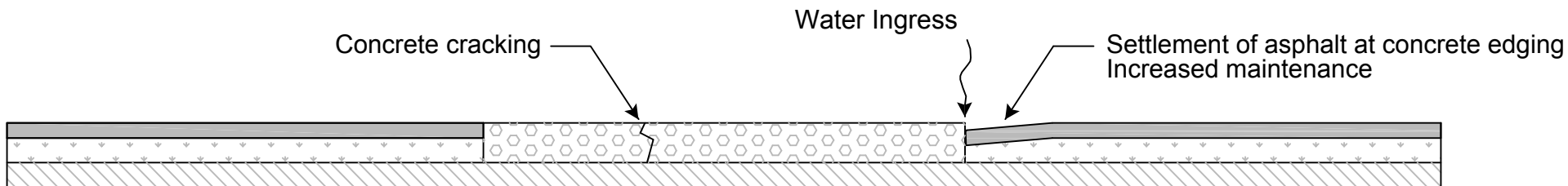

Stamped Concrete Cross Walk - after a few winters

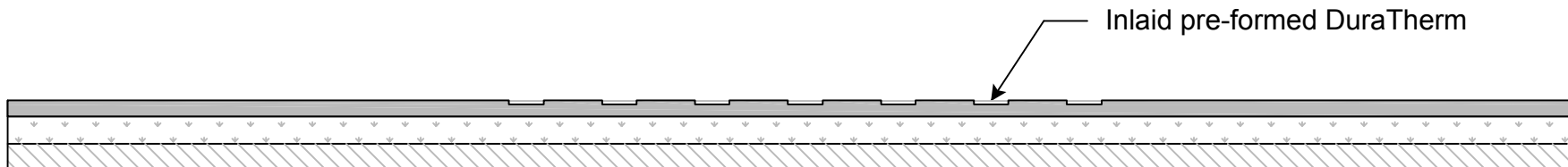

DuraTherm Cross Walk - contiuous asphalt

Features and Benefits of DuraTherm Crosswalk:

- | | |
|--|------------------------------------|
| 1 Less disruption to traffic with a cure time of 6-8 hrs vs. 72 hrs for stamped concrete | 4 Good skid resistance |
| 2 Continuous surface - no water ingress | 5 No cracking |
| 3 Easy to recoat/rejuvenate surface color | 6 Permanent pattern |
| | 7 Easy to repair after utility cut |

Drawing No. DT-103

STAMPED CONCRETE CROSS WALK vs DURATHERM CROSS WALK



FLINT TRADING, INC.
336-475-6600 | www.flintrading.com